



9 Douglas Drive, Stirling
Offers Over £139,995



sneddons
solicitors & estate agents **S.S.C.**

1/3 South Street, Bo'ness, West Lothian, EH51 0EA

T: 01506 826232

E: property@sneddons.com

W: www.sneddons.com

Description

Situated in the popular Broomridge area of Stirling and occupying a peaceful setting in a quiet cul de sac is this lovely semi detached villa. This property will suit the first time buyer as well as someone looking to downsize. The property benefits from gas central heating, double glazing, good storage and off street parking. Early viewing is strongly advised.

Accommodation

Accommodation is arranged over two levels, The lower level includes reception hallway and a naturally bright and airy lounge with a featured fireplace as the focal point. The dining room is accessed from the lounge and is open plan to the kitchen. The kitchen has a range of base and wall units, complementary work tops and a four ring gas hob.

The upper level houses two double bedrooms both with built in wardrobes. The bathroom has a shower above the bath.

Outside

The enclosed garden to the rear has been well tended and has an area laid to grass with borders of mature plants, shrubs and bushes, There is also a paved patio area. The garage can be accessed from the garden. The garden to the front is also laid to lawn. A tarmacadam driveway gives off street parking and access to the garage. The garage has power and light to it.

Local Area

Stirling has excellent commuter links to both Edinburgh and Glasgow offers excellent local amenities including Thistle shopping Mall, primary and secondary schooling and various recreational pursuits.

Lounge

4.53m x 3.21m (14'10" x 10'6")

Kitchen Diner

2.59m x 4.18m (8'6" x 13'9")

Bedroom 1

2.56m x 2.55m (8'5" x 8'4")

Bedroom 2

2.86m x 3.20m (9'5" x 10'6")

Bathroom

2.30m x 1.54m (7'7" x 5'1")

Contact Us

To arrange a viewing or for further details please call 01506 826232 or email property@sneddons.com.



sneddons
solicitors & estate agents **S.S.C.**



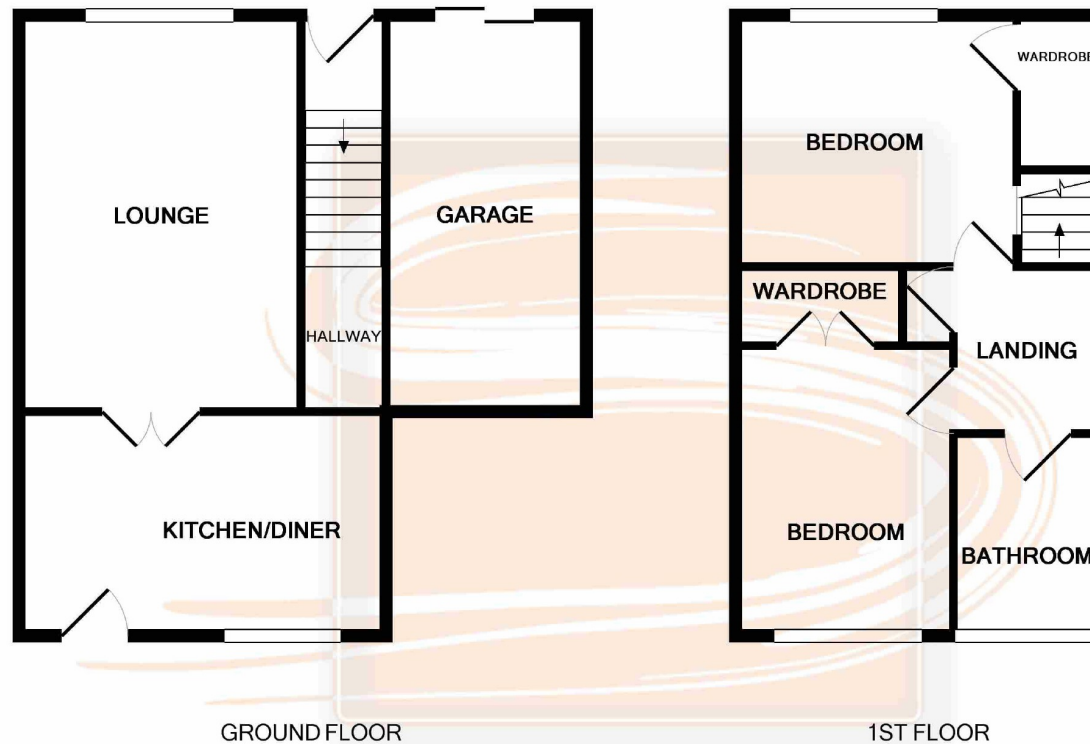

Whilst every attempt has been made to ensure the accuracy of the floor plan contained here, measurements of doors, windows, rooms and any other items are approximate and no responsibility is taken for any error, omission, or mis-statement. This plan is for illustrative purposes only and should be used as such by any prospective purchaser. The services, systems and appliances shown have not been tested and no guarantee as to their operability or efficiency can be given
Made with Metropix ©2019

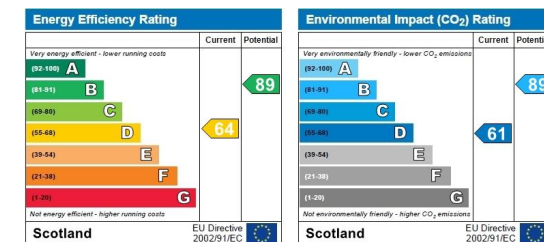

Sneddons for themselves and their clients the owners, give notice that while these particulars are believed to be correct their accuracy is not warranted. All measurements are approximate only. Interested parties are advised to satisfy themselves as to all details and sizes of the property prior to submitting any offer. These particulars are for information only and are not intended to, nor shall they, form part of any contract relative to the property.

If you have a property to sell then why not take advantage of our **FREE VALUATION** service - contact us for a no obligation appraisal of your property.

1/3 South Street, Bo'ness, West Lothian, EH51 0EA

T: 01506 826232

E: property@sneddons.com

W: www.sneddons.com



sneddons
solicitors & estate agents **S.S.C.**

