



sneddons
solicitors & estate agents



65 Restalrig Road South

, Edinburgh,

£245,000



Description

65 Restalrig Road South, Restalrig, Edinburgh, United Kingdom

This lovely property, nestled in a quiet cul-de-sac, presents an exciting opportunity for those seeking a home with character and potential. Move-in ready, yet offering room for personalization, this residence is perfect for families and first-time buyers alike.

Key Features:

Accommodation Over Two Levels: The layout is thoughtfully arranged, with the ground floor hosting a welcoming reception hallway. As you step inside, the lounge immediately catches your eye. Flooded with natural light from windows at both the front and rear, it provides a comfortable space for relaxation and entertainment. There's even ample room for a dining table, making it ideal for family gatherings.

Well-Equipped Kitchen: The kitchen boasts practicality and style. Wall and base units offer plenty of storage, while complementary worktops create a functional workspace. Appliances include an electric hob, oven, washing machine, and fridge freezer—a setup that caters to modern living.

Two Double Bedrooms: Ascend to the upper level, where you'll find two generously sized double bedrooms. Both rooms feature built-in storage, ensuring clutter-free living.

Convenient Shower Room: Completing the accommodation, the shower room provides a refreshing space to start or end your day.

Outdoor Spaces:

Spacious Rear Garden: The enclosed rear garden is both child-friendly and low-maintenance. Whether it's playtime or relaxation, this outdoor space offers versatility.

Front Garden and Driveway: The front garden is designed for easy upkeep, and the driveway provides off-street parking—a valuable asset in any neighborhood.

Local Area

Lounge 19'8" x 10'11" (6.00 x 3.34)

Kitchen 10'5" x 8'2" (3.2 x 2.5)

Bedroom 1 9'6" x 16'0" (2.9 x 4.9)

Bedroom 2 9'6" x 10'11" (2.9 x 3.35)

Shower Room 5'5" x 6'3" (1.67 x 1.93)

Contact Us

Area Map



Floor Plans

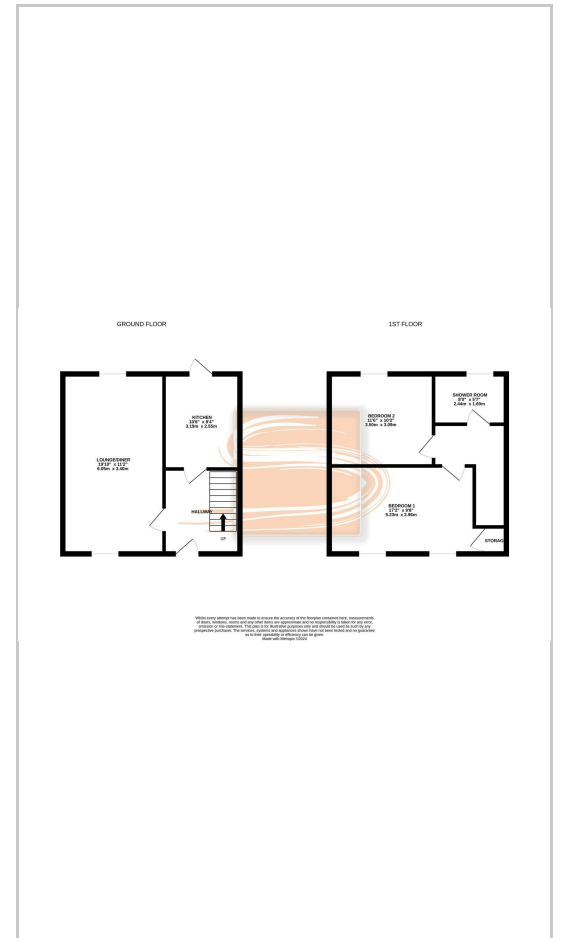

Energy Efficiency Graph

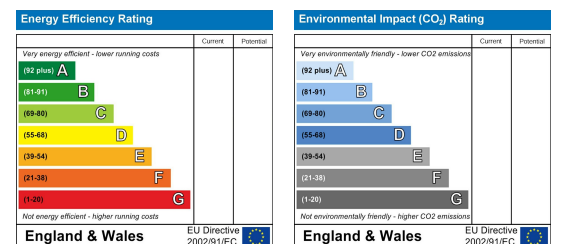

These particulars, whilst believed to be accurate are set out as a general outline only for guidance and do not constitute any part of an offer or contract. Intending purchasers should not rely on them as statements of representation of fact, but must satisfy themselves by inspection or otherwise as to their accuracy. No person in this firm's employment has the authority to make or give any representation or warranty in respect of the property.

47/49 West Main Street, Armadale, West Lothian, EH48 3PZ

Tel: 01501 733200 Email: property@sneddons.com www.sneddons.com